

groov>e

USER MANUAL

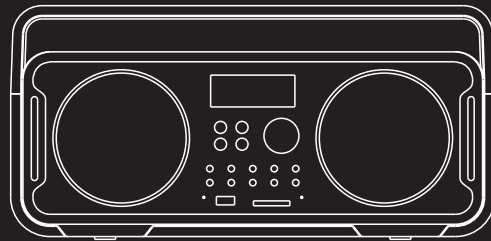

Model : GVSP480
Wireless Portable Music System



The lightning flash and arrowhead within the triangle is a warning sign alerting you of "dangerous voltage" inside the product.

CAUTION

RISK OF ELECTRIC SHOCK
DO NOT OPEN

WARNING:

To reduce the risk of electric shock, do not remove cover (or back). No user-serviceable parts inside. Refer servicing to qualified service personnel.



CAUTION:

The exclamation point within the triangle is a warning sign alerting you of important instructions accompanying the product.



CAUTION:

To reduce the risk of fire or electric shock or damage, do not expose this appliance/ apparatus (including all its accessories such as AC-adaptor, etc.) to dripping or splashing liquids, and no object filled with liquids should be placed on the appliance/ apparatus (including all its accessories).

PLEASE NOTE: YOU WILL FIND THE RATING LABEL FOR THIS PRODUCT LOCATED ON THE REAR OF THE UNIT.

CAUTION: GROUNDING OR POLARIZATION: THE PRECAUTIONS SHOULD BE TAKEN SO THAT THE WIDER BLADE OF THE AC PLUG (OF AC-ADAPTOR) MUST MATCH THE SLOT IN RECEPTACLE "WALL SOCKET". (ONLY IF YOUR AC PLUG IS POLARIZED)

NOTE: CAUTION SYMBOLS ARE PRINTED ON REAR OF UNIT OR ACCESSORIES. PLEASE REFER TO INSTRUCTION MANUAL.

EXCESSIVE SOUND PRESSURE FROM EARPHONES AND HEADPHONES CAN CAUSE HEARING LOSS.

CAUTION : DANGER OF EXPLOSION IF BATTERY IS INCORRECTLY REPLACED. REPLACE ONLY WITH THE SAME OR EQUIVALENT TYPE. BATTERY REPLACEMENT MUST ONLY BE DONE BY A QUALIFIED PROFESSIONAL TECHNICIAN.

ELECTROSTATIC DISCHARGE (ESD) PRECAUTION

WHEN ELECTROSTATIC DISCHARGE (ESD) OCCURS AT THE FRONT SURFACE (WHETHER METAL OR PLASTIC) OR NEAR ANY PART OR ANY BUTTON OF THIS UNIT, OR AT THE USB PORT AND/ OR SD-CARD SLOTS (IF THEY EXIST ON THIS PRODUCT), THERE MAY BE A POSSIBILITY THAT THE PRODUCT MAY STOP OPERATION AND/ OR SHUT DOWN IMMEDIATELY. THIS IS A NORMAL CONDITION AND INTENDED TO PROTECT THE UNIT AND INTERNAL COMPONENTS AGAINST DAMAGE.

IN SUCH A CASE, PLEASE RESET THE UNIT (BY POWERING OFF THE UNIT AND DISCONNECTING AND RECONNECTING AC-POWER SOURCE) TO REVERT THE UNIT TO NORMAL OPERATION.

- KEEP MINIMUM DISTANCES (5cm) AROUND THE APPARATUS FOR SUFFICIENT VENTILATION.
- THE VENTILATION SHOULD NOT BE IMPEDED BY COVERING THE VENTILATION OPENINGS WITH ITEMS SUCH AS NEWSPAPER, TABLE-CLOTHS, CURTAINS ETC.
- NO NAKED FLAME SOURCE SUCH AS LIGHTED CANDLES SHOULD BE PLACED ON THE APPARATUS.
- ATTENTION SHOULD BE DRAWN TO THE ENVIRONMENTAL ASPECTS OF BATTERY DISPOSAL.
- THIS APPLIANCE/ APPARATUS IS INTENDED FOR USE IN A MODERATE CLIMATE AND INDOOR USE.

LOCATION OF CONTROLS

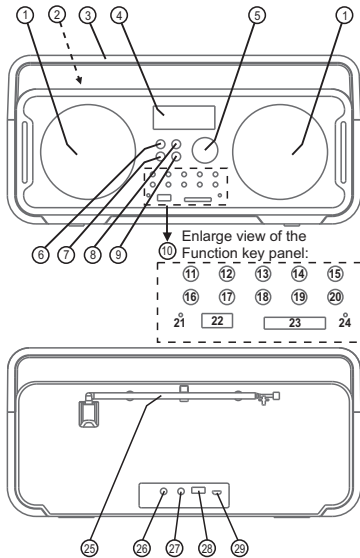

1. Main Speaker (Left & Right)
2. Slot for placing your Smartphone/ Tablet
3. Handle
4. Liquid Crystal Display
5. Volume Control Knob
6. Bass + Key
7. Bass - Key
8. Treble + Key
9. Treble - Key
10. Function Key Panel
11. Power Button
12. Tune - / Back Key
13. Play / Pause / Pairing Key
14. Tune + / Next Key
15. Function Key
16. 10 Song Skip Forward Key (MP3)
17. P-mode / FM mode Key
18. Stop / Program Key
19. Memory - / Folder - Key
20. Memory + / Folder + Key
21. Charging Indicator LED
22. USB MP3 Port
23. SD Card Slot
24. Pairing Indicator LED
25. Telescopic antenna
26. Headphone Jack
27. Auxillary Input
28. USB Charging Port
29. DC Input (Micro USB)

POWER SOURCE

- This unit runs via internal rechargeable Lithium-ion battery.
- It can be recharged from any standard USB port (eg. PC USB port.)
- It can be also recharged with the provided Micro-USB AC adaptor.
- Please ensure your country's AC-voltage is within the AC-Adaptor's voltage range.
- Insert the micro USB plug of the AC Adaptor into the Micro USB Socket at the back of the unit.
- Plug the AC adaptor into a wall outlet with AC power.
- Press "On/Standby" key to switch ON the unit.
- The unit is charging if the charging LED indicator is on.
- Once the unit has been charged, it can simply be unplugged and taken anywhere to be used.
- Total play time when fully charged is about 5-6 hours.
- When the unit is not being used, we suggest to keep it plugged in and charging.

IMPORTANT

FOR BEST RESULT, FULLY CHARGE THE UNIT BEFORE USE EACH TIME.
IF THE BATTERY IS FULLY DRAINED, PLEASE ALLOW IT TO RECHARGE
FOR A FEW HOURS BEFORE USE

E-3

OPERATION

SOUND CONTROL:

- Adjusting loudness can be done by using the volume control on this unit and also the volume control of the device you have already connected to (if using Bluetooth or AUX-Input Jack).
- You can also adjust the bass & treble knob (for stronger bass/ highs) for quality sound effect.

IMPORTANT: If there is NO sound, ensure the volume on both devices is not set to 0.

- To enhance the quality of music, this powerful sound system comes with two additional equalization functions. At anytime during playback, you can use the Bass (b) and Treble (t) button (+/-) for stronger bass / highs.
- The display will indicate the levels of the bass / treble (b/t), based on your adjustments.

FUNCTION KEY

Pressing the FUNCTION [F] Key repeatedly will allow you to see and select one of the different source functions, as follows :

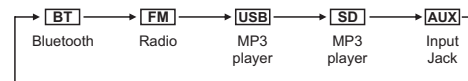

Bluetooth® WIRELESS PLAYBACK (A2DP Audio Streaming)

- This unit can wirelessly playback audio from any device with Bluetooth A2DP function.
- The wireless range is approximately within 10m (30Ft.)
- Simply pair your device (eg. Smartphone) to this unit to enjoy Wireless Audio Streaming.

How to pair your device to this unit:

- Make sure Bluetooth is switch ON in your Device (Smartphone/ Tablet).
- Switch on the speaker unit, and press "FUNCTION" key repeatedly until display shows BT.
- Once the PAIRING LED Indicator begins flashing, you will find the unit listed in the Bluetooth® connection list of your device (eg. In your Smartphone or Tablet).
- Make connection on your device (eg. Press "CONNECT").
- If asked for a pass code, enter "GVSP480."
- This is one-time event per device. To pair your unit with another device, please repeat the above steps. The unit remembers up to 4 devices.
- There is no need to repeat this pairing procedure for up to 4 devices, even if unit is powered off.
- The unit will also automatically pair with the LAST paired device if it is found when the unit is powered ON and switched to Bluetooth® mode.
- Note that only one device can be paired at any given time, but the unit will remember up to 4 devices in memory.
- The PAIRING LED light will indicate the Bluetooth Status of the unit:

STATUS	PAIRING LED LIGHT
Searching	LED flashes slowly
Pairing	LED blinks faster
Connected	LED stays on

E-4

OPERATION

USING THE FM RADIO

- Press "FUNC" key repeatedly until display shows FM.
- To improve radio reception, adjust position of the unit. To further enhance reception, extend the telescopic antenna found at the rear of the unit.
- After tuning into a desired station, use "FM MODE" key to select (MONO/STEREO) mode.
- In some case, when the reception is poor, we highly recommend to use "MONO" mode for better clarity.



Manual Frequency Adjustment (Scan Mode)

- Press & immediately release "TUNE+" or "TUNE-" key to manually adjust the radio frequency 1 step at a time.
- When the desired station is reached, it can be saved into one of the "MEMORY" positions. (See "Radio Memory" section for further details).

Automatic Frequency Adjustment (Seek Mode)

- Press & Hold (For 2 seconds) "TUNE+" or "TUNE-" key to seek the next available radio station frequency.
- When the desired station is reached, it can be saved into one of the "MEMORY" positions. (See "Radio Memory" section for further details).

Radio Memory

- After tuning into a desired station, it can be stored into one of the 20 available memory positions.
- Short Press "PROG." key to go to memory tuning mode. Display will show "P-01" (FLASHING).
- Press & release "MEMORY+" or "MEMORY-" key to choose the desired memory storage position you would like to store into (P-01 to P-20).
- Short Press "PROG." key again to confirm selection. The display will stop flashing.

Recalling a saved memory station

- Short press "MEM+/" "MEM-" key to find a saved memory position.
- To erase a saved radio station, simply replace it with a new station in same memory position.

E-5

OPERATION

USB & SD CARD MEMORY PORTS (For MP3 PLAYBACK)

- The following chart shows how to use USB/SD mode:

KEY	For USB thumb drive & SD Card
FUNC.	Press repeatedly until "USB" or "SD" is displayed
+ 10	Skips 10 tracks forward during MP3 play (USB / SD card)
FOLDER +/- FOLDER -	Choose folder location on your USB/ SD Card (Not usable in RANDOM play mode)
NEXT	Skip to next song
BACK	Skip to previous song
PLAY/ PAUSE	Start playback or pause playback
P-MODE	
STOP	Stop playback

NOTE:

It takes time to "Open & Verify" a large USB-Drive/ SD-Card, and count all the song files. If there are many files, it can take up to 60 seconds for this process.

IMPORTANT: REMOVAL OF USB DRIVES & SD CARDS

Never remove SD Cards or USB drives from the unit during playback. Always STOP playback, then press "FUNCTION" key to switch to another mode (FM/BT/AUX) before removing your USB/SD memory to prevent damage to your song files and memory devices itself.

Using Audio Line-in Connection (AUX-input)

- This unit comes with an Audio Line-input jack (Labelled Aux-Input), allowing you to connect a device using an Auxillary cable.
- Connect your external device to this unit using a standard stereo headphone (3.5mm to 3.5mm) cable.
- Press "FUNCTION" key repeatedly until display shows "AUX".
- Switch on your external device & activate playback on it.
- Playback of external device will start momentarily. Adjust the volume control of the main unit and your external device to the desired level.
- Playback control can be done only through your external device.
- Remember to switch off the unit when you finish using the external device.

USB charging port

This unit is equipped with a DC 5V USB charging port on the back panel. To utilize this feature, simply connect the device you would like to charge (eg. Smartphone or Tablet) to a suitable USB cable and plug it into the USB charging port. (This function is only active when the unit is plugged into an AC adaptor). The external device will be charged automatically when it is successfully connected, even during playback.

SPECIFICATIONS

Power Supply : Rechargeable Lithium 3.7V/ 2100mAh X 1 PC. (Built-in)
 Recharge Power : USB 5V (500mA)



E-6